

Notes:

1. Fence panel is designed to be used with ACPS Barrier Fence Posts and shall be supported at max. 10 ft post interval. The supporting posts shall have sufficient capacity to carry load transferred from fence panel.
2. Each 10ft fence panel is designed to resist 1.0 kN concentrate horizontal load on the top rail.
3. Use ASTM A500 Grade C, Fy=50 ksi for all tubing.
4. All metal parts shall be hot-dip galvanized.

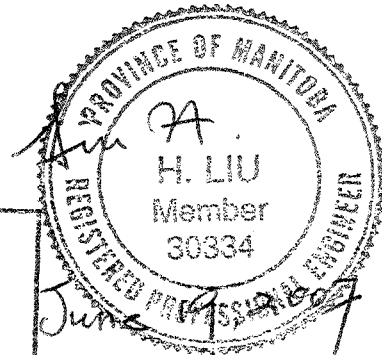

APCO
 Certificate of Authorization
 All Cover Portable Systems
 No. 4025 Date: June 19, 2007

Out Front Portable Solutions
 A Division of All Cover Portable Systems
 4664 Ontario St. Beamsville ON

PART NUMBER BF 1035		FENCE		DWG NO ACPS05-5740		DO NOT SCALE DWG		PRINT 11 x 17	REV 0
CATEGORY	WELDMENT								
DRAWN	riese.heemskerk	10/5/2005	STATUS					SHEET	1 OF 1

MULTI PURPOSE BARRIER FENCE POST PART NO BFP01 & BFP02

MATERIAL GALVANIZED STEEL

Notes:

1. The fence post is designed to resist 1.0 kN concentrate horizontal load or 1.5 kN concentrate vertical load acting on the top of the post.
2. Use ASTM A500 Class B/C shaped tubing for post.
3. For post base anchorage, use ASTM A-307 bolts with minimum four 5/16" dia bolts at each base.

Parts List	
ITEM	DESCRIPTION
1	.25 X 12 X 12
2	.083 X 2 X 2
3	0.25 X 1.25
4	0.25 X 1.25

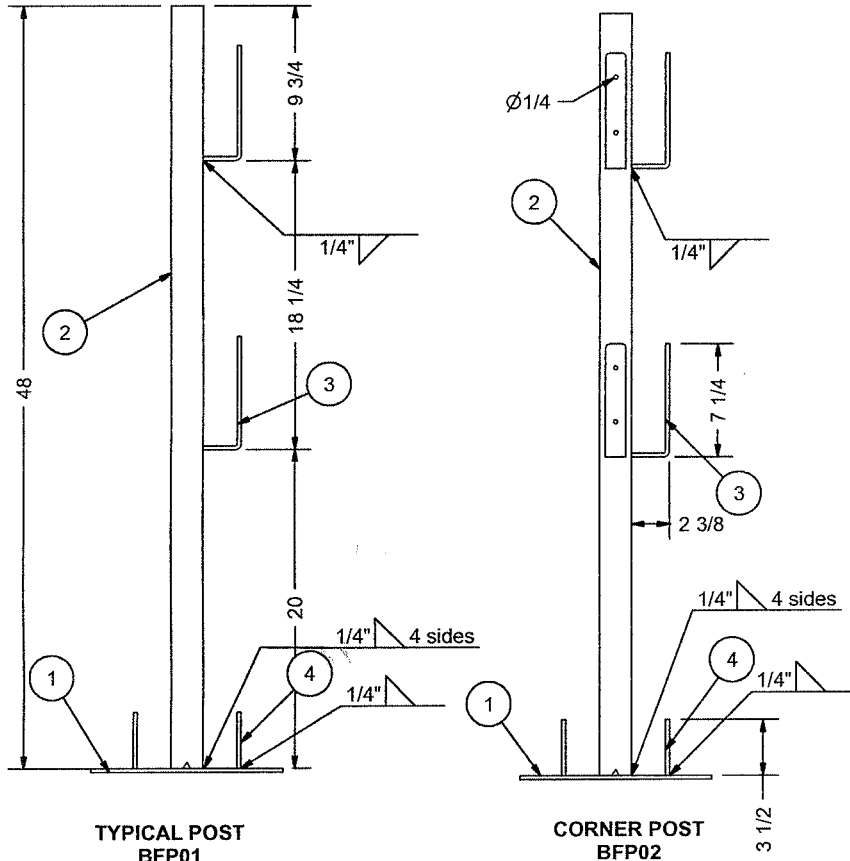
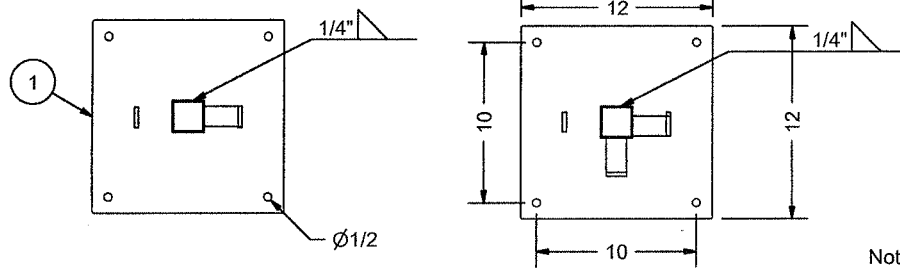

DRAWN riese.heemskerk	2/13/2006	All Cover Portable Systems 4664 Ontario St. Beamsville Ont.	
CHECKED RIESE		TITLE BARRIER FENCE POSTS BFP01 & BFP02	
MFG RIESE		SIZE 11 x 17	DWG NO ACPS05-1488
ENG. RIESE			REV 0
APPROVED		PART NO BARRIER_FENCE_POLE	DO NOT SCALE DWG SHEET 1 OF 1

© 2006 All Cover Portable Systems All Rights Reserved

This drawing may not be copied or reproduced by any means without their explicit written permission.

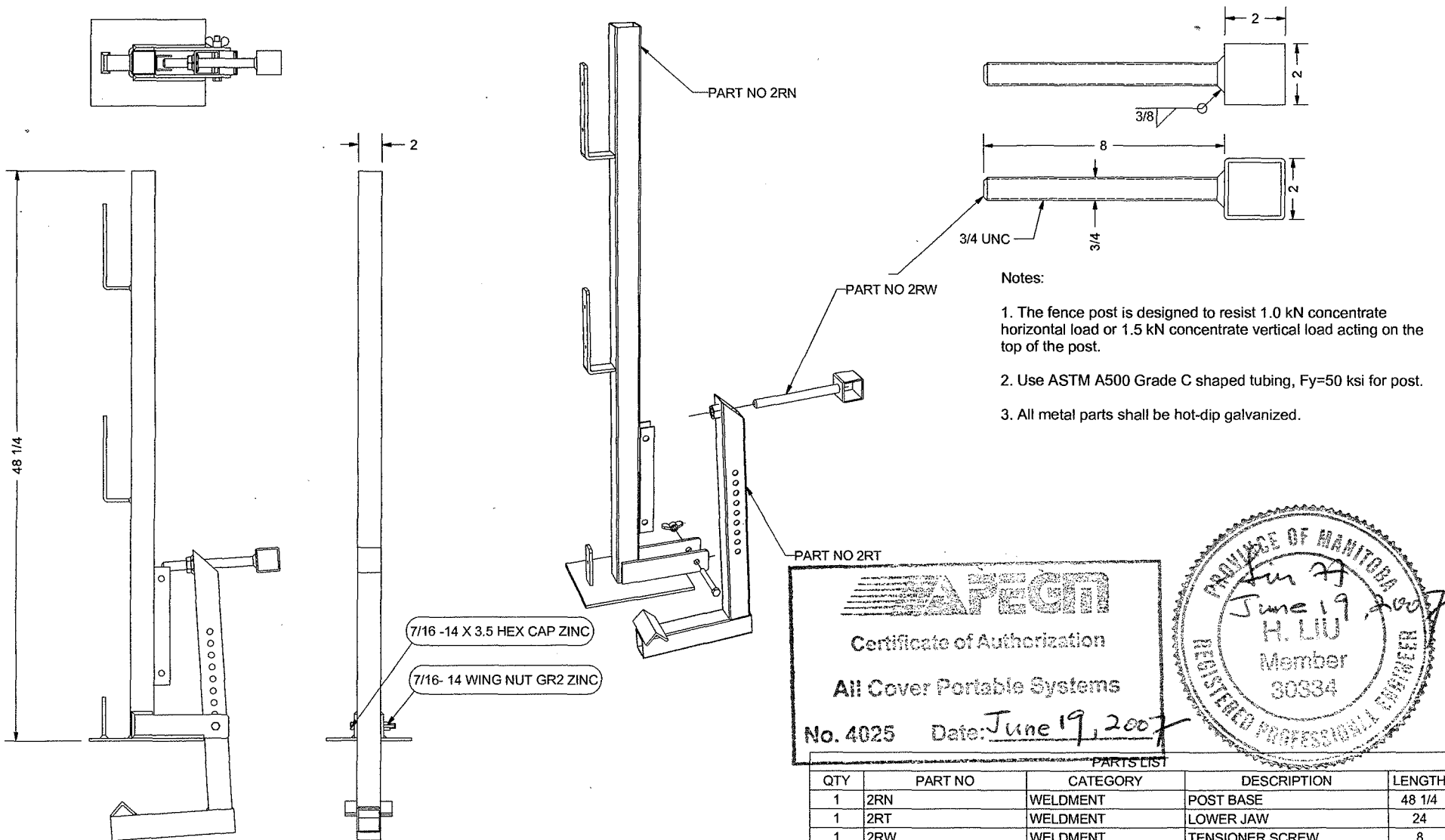

Notes:

- 1. The fence post is designed to resist 1.0 kN concentrate horizontal load or 1.5 kN concentrate vertical load acting on the top of the post.
- 2. Use ASTM A500 Grade C shaped tubing, Fy=50 ksi for post.
- 3. All metal parts shall be hot-dip galvanized.

PECC
 Certificate of Authorization
 All Cover Portable Systems
 No. 4025 Date: June 19, 2007

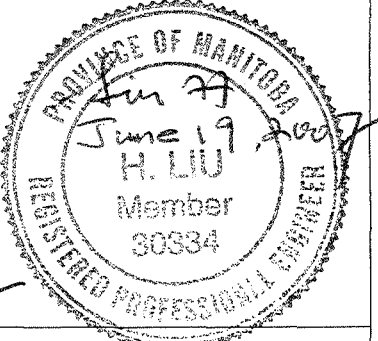

PARTS LIST					
QTY	PART NO	CATEGORY	DESCRIPTION	LENGTH	
1	2RN	WELDMENT	POST BASE	48 1/4	
1	2RT	WELDMENT	LOWER JAW	24	
1	2RW	WELDMENT	TENSIONER SCREW	8	
1	7/16 x 3 1/2 UNC	FAST -HEX BLT	7/16 -14 X 3.5 HEX CAP ZINC	3 1/2	
1	17 - 7/16 - 14- WING NUT	FAST -HEX NT	7/16- 14 WING NUT GR2 ZINC		

Out Front Portable Solutions
 A Division of All Cover Portable Systems
 4664 Ontario St. Beamsville ON

PART NUMBER	BF-1035		FENCE		DWG NO	ACPS05-5747	DO NOT SCALE DWG	PRINT	REV
CATEGORY	ASSEMBLY							11 x 17	0
DRAWN	riese.heemskerck	12/1/2006	STATUS				SHEET	1 OF 3	

2

1

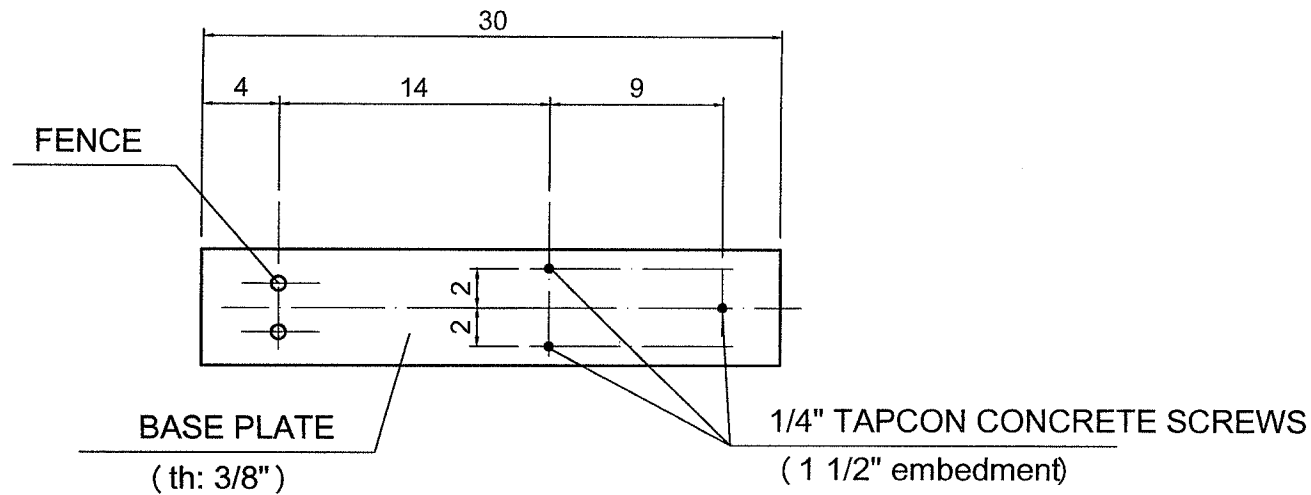

Notes:

1. Design is based on 200 lbs lateral concentrate load applied on top of each fence panel; fence height is 3'-6".
2. For assmeby details, see BF-BASE-30, DWG No. ACPS05-1114.
3. For anchor bolts, use TAPCON Concrete Screws; concrete $f'c = 20\text{MPa}$.
4. For concrete screw detail and instructions, refer to TAPCON product specifications.
5. Dimensions in inches.
6. Alternative anchorage is selected for this revision.

This drawing remains the property of All Cover Portable Systems and may not be copied or used without written authorization.

DRAWN Hongtao Liu 11/7/2005	ALL COVER PORTABLE SYSTEMS		
CHECKED	TITLE		
QA	SAFE-T-FENCE BASE CONNECTION DETAILS		
MFG	SIZE	DWG NO	REV
APPROVED	A	ACPS-FENCE S-1	1
	SCALE	SHEET 1 OF 1	



2



1